

Trouble Shooting - Siren

Checking the Siren:

If siren does not give a tone on arm & disarm (non EU countries only)

- Check that the Arm/Disarm Indication Tone is not programmed off.
- Check that the siren plugs have not been disconnected from rear of the siren or the ECU and that all the pins are in the correct locations and secure.

If siren will not sound when the alarm is triggering

- Check that the siren plugs have not been disconnected from rear of the siren or the ECU and that all the pins are in the correct locations and secure.
- Ensure the correct siren is fitted to the security system. Remember ECUs can no longer be programmed to accept either type of siren

- S1** – High Power Audio Siren (2 wire)
- S4** – High Power Audio Siren (2 wire)
- S12** – High Power Audio Siren (2 wire)
- S30** – Battery Back-Up Siren (3 wire)
- S32** – Battery Back-Up Siren (3 wire)
- S34** – Battery Back-Up Siren (3 wire)

If the 4 way plug is correctly pinned (see below) and the siren is a correct match to the alarm unit (see above), the siren housing front can be removed to test the siren as illustrated, but only if instructed to do so by the technical department. **Breaking the siren seal without authorisation will invalidate the warranty.**

Ensure that the bulb tester is no greater than 10 watts before carrying out this test!!

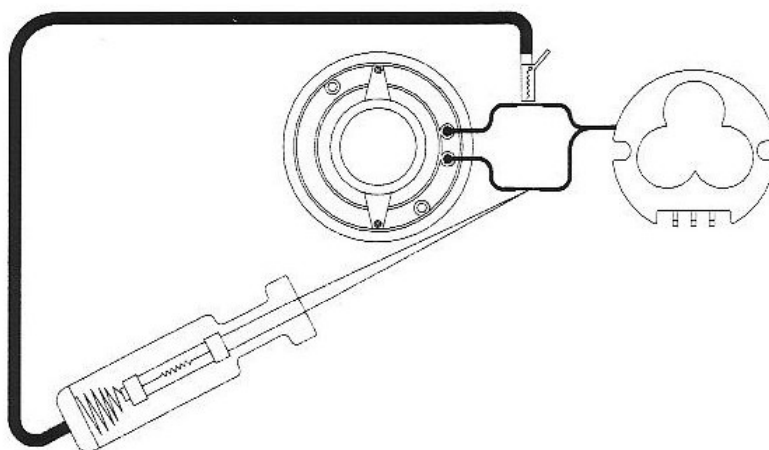
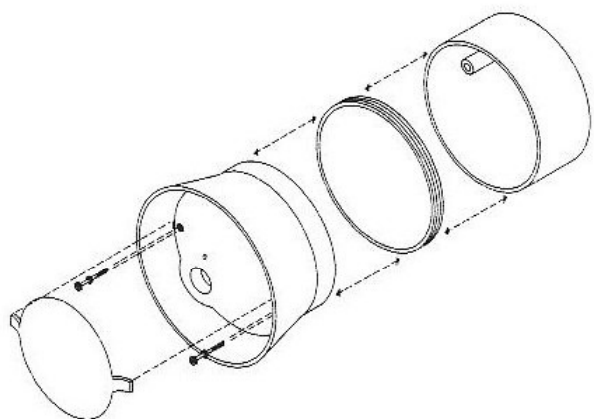

Using a standard automotive test lamp, connect across the connections on the rear of the siren housing front. Arm and trigger the alarm system. If the alarm system is functioning correctly the tester will illuminate. If the tester is not illuminating check the soldered connections to the siren housing front.

Siren 4 Way Plug Connections:

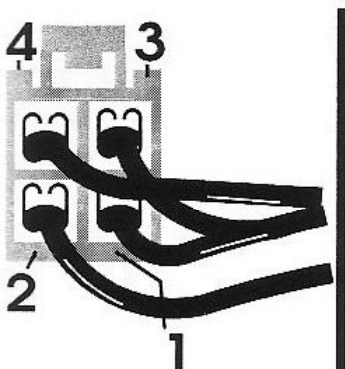

Numbers 1 to 4 can be found embossed on the edge of the plug as illustrated. Connections 1 to 4 are as follows:

Plug No	Audio Siren Connections:	Battery Back-Up Siren Connections:
1 (Red)	= NOT CONNECTED	+ 12 Volt Supply
2 (Brown)	= Bonnet Switch	Bonnet Switch
3 (Yellow)	= Audio Output	Data Link
4 (Green)	= Audio Output	Negative Supply